

MATERIAL OF CONSTRUCTION

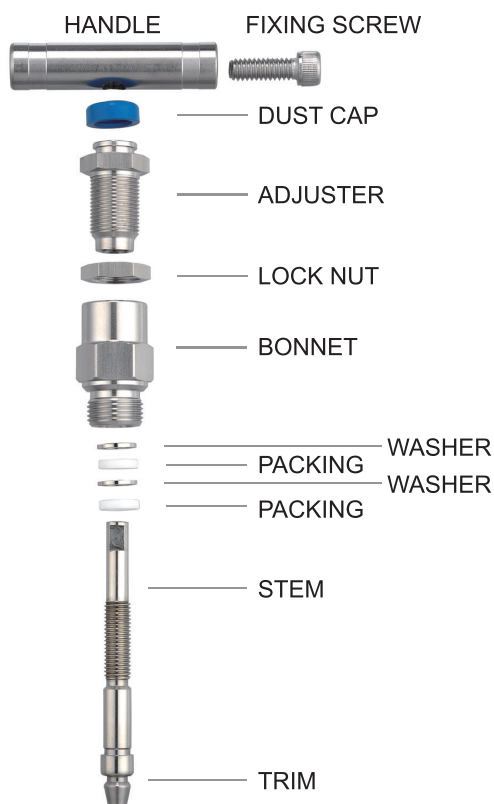

FEATURES

- Maximum working pressure: 10000 psi (690bar) at 100°F (38°C)
- Working temperature: -65°F (-54°C) to 464°F (240°C)
- PTFE packings can be adjusted to extend the valve life.
- Non rotating stem design to reduce the galling and provide excellent seal on seat.
- Stem threads are rolled and lubricated to prevent galling and reduce operating torque.
- Sealing area below the threads protects from the contaminant by process and prevents lubricant washout.
- Safety back seating seal in fully open position to perform a secondary stem seal.
- Body to bonnet seal creates metal to metal constant and reliable compression.
- Bonnet lock pin prevents accidental removal while in service.
- Optional sour gas service conforms to NACE MR0175.
- Hydro test performed with pure water at 1.5 times of working pressure
- 100% factory test
- Material traceability

Dimensions

Size	Ends	L	L1	H	H1	Bore	W
1/4" NPT	MXF	2.40	1.18	4.52	1.26	.24	2.24
1/2" NPT	MXF	2.40	1.18	4.52	1.26	.24	2.24
3/4" NPT	MXF	2.40	1.18	4.52	1.26	.24	2.24

Component	Valve Body Material	
	316L S.S.	Carbon Steel
Body	316L S.S./A479	Carbon Steel /A108
Bonnet	316L S.S./A479	Carbon Steel /A108
Stem	316L S.S./A276	304 S.S./A276
Adjuster	316L S.S./A276	Carbon Steel /A108
Lock Nut	316L S.S./A276	Carbon Steel /A108
Handle	303 S.S./A276	Carbon Steel /A108
Fixing Screw	302 S.S.	Zinc plated steel
Packing	PTFE	PTFE
Washer	316 S.S./A276	316 S.S./A276
Dust Cap	NBR	NBR
Lock Pin	303 S.S./A276	303 S.S./A276
Bleed Screw	316 S.S./A276	316 S.S./A276